

APT MODEL 190 PAVING BREAKER

PART # 5239 (1-1/8" HEX)

PART # 5240 (1-1/4" HEX)

BALL VALVE TYPE

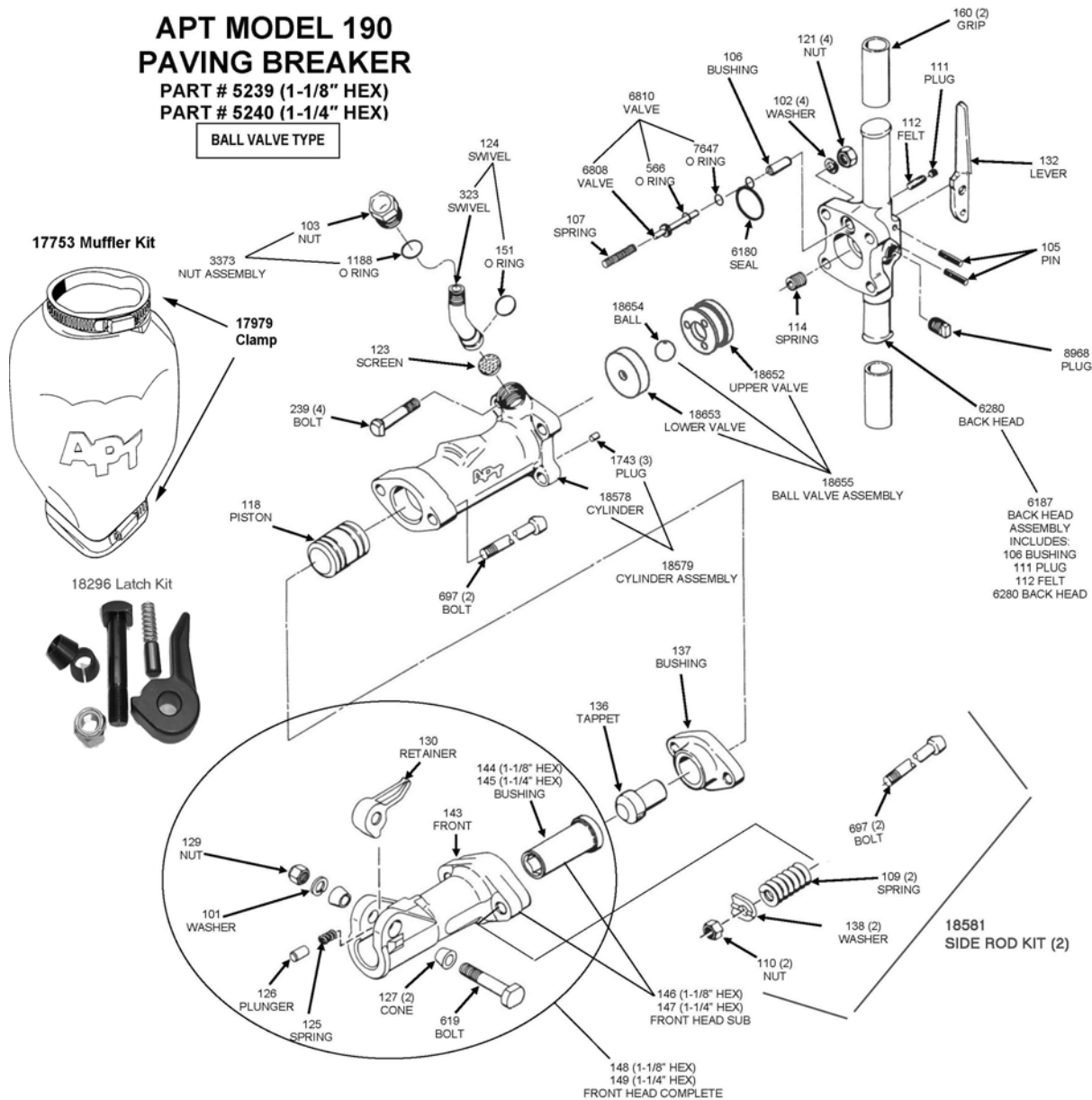

Index No	Part No	Description
1	101	LOCK-WASHER
2	102	WASHER (split lock)
3	103	NUT, AIR INLET SWIVEL
4	105	PIN, ROLL
5	106	BUSHING, TV
6	107-APT	SPRING (throttle valve)
7	109-APT	SPRING (front head / side rod)
8	110-APT	NUT (fronthead bolt)
9	111	PLUG, DRY SEAL, PRESSURE
10	112-APT	FELT, OIL CONTROL
11	114-APT	SPRING, PLUNGER
13	118-APT	PISTON (APT-180 & 190)
14	1188-APT	ORING (swivel nut, APT-180, 190)
15	121-APT	NUT (hex)
16	123-APT	SCREEN
17	124-APT	PIPE (air inlet swivel with oring)
18	125-APT	SPRING, PLUNGER
19	126-APT	PLUNGER
20	127-APT	CONE-RUBBER

Manufacturer: American Pneumatic**Model: APT-190 (BV)**

21	129-APT	NUT, ELASTIC STOP
22	130-APT	LATCH (steel retainer)
23	132-APT	LEVER, THROTTLE
24	136-APT	TAPPET (APT-190)
25	137-APT	BUSHING (tappet seat, APT-190)
26	138	LOCKWASHER (fronthead bolt)
27	144-APT	BUSHING. 1-1/8in HEXAGON
28	145-APT	BUSHING, 1-1/4in HEXAGON
29	146-APT	FH (APT-190, W/ 1-1/8in hex)
30	147-APT	FH (APT-190, w/ 1-1/4in hex)
31	148-APT	FH COMPLETE (APT-190, 1-1/8in)
32	149	FH COMPLETE (APT-190, 90lb 1-1/4in)
33	151-APT	ORING (swivel pipe, APT-180, 190)
34	160-APT	GRIP, HANDLE
35	18296	LATCH KIT (APT160, 180)
36	18581	SIDE ROD KIT (190)
37	18652	UPPER VALVE SEAT, M190
38	18653	LOWER VALVE
39	18654	BALL, MAIN VALVE, 190
40	18655	BALL VALVE ASSEMBLY, M190
41	239	BOLT (backhead, APT 160, 180, 190)
42	323-APT	SWIVEL
43	3373-APT	NUT (air inlet swivel with oring)
44	566-APT	ORING (tv stem)
45	6180	SEAL (90LB)
46	6187-APT	BACKHEAD ASSY
47	619-APT	BOLT-RETAINER
48	6280-APT	replaced by: 6187-APT backhead
49	6810-APT	THROTTLE VALVE (3364)
50	697-APT	BOLT
51	7647	ORING (tv seat - APT 160, 180, 190)
90	APT-190-1-1/8	BREAKER (90lb 1-1/8in chuck)
52	8968	PLUG, OIL
91	APT-190-1-1/4	BREAKER, 90LB, 1-1/4in CHUCK
53	17753	MUFFLER, APT 90lb
54	17979	MUFFLER CLAMP